

Range hood

DF-E5 / DF-E6

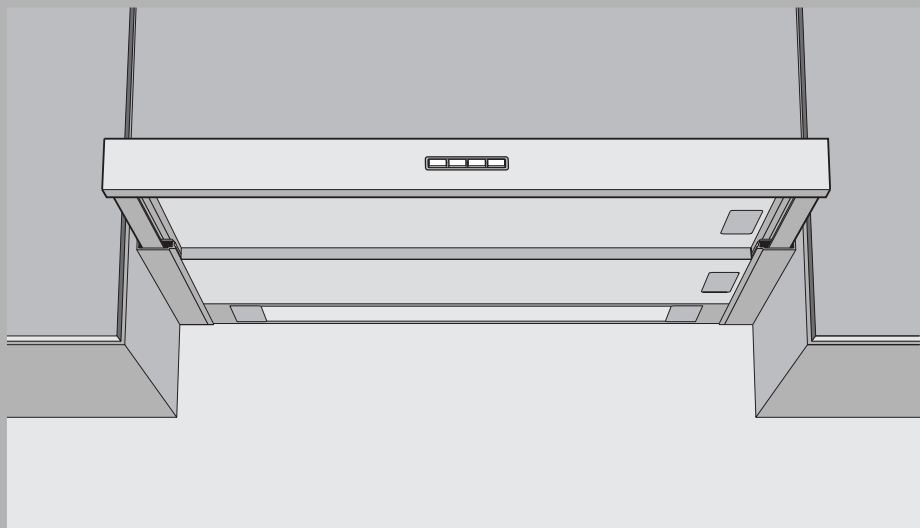

Operating instructions

Thank you for choosing to buy one of our products. Your appliance is made to high standards and is easy to use. Nevertheless, please take the time to read these operating instructions in order to familiarize yourself with the appliance and get the best use out of it.

Please follow the safety precautions.

Modifications

Text, diagrams and data correspond to the technical standard of the appliance at the time these operating instructions went to press. The right to make technical modifications for the purpose of the further development of the appliance is reserved.

Symbols used



Denotes important safety precautions. Failure to observe said precautions can result in injury or damage to the appliance or fittings!

- ▶ Indicates step-by-step instructions.
- Describes how the appliance reacts to the steps taken.
- Indicates a list.



Denotes useful tips for the user.

Validity

The model number corresponds to the first three digits on the identification plate. These operating instructions apply to the models:

Type	Model no	Size system
DF-E5	328	55
DF-E6	329	60

Variations depending on the model are noted in the text.

Contents

1	Safety precautions	4
1.1	Before using for the first time	4
1.2	Correct use	5
1.3	Children in the home	5
1.4	Note on use	6
2	Appliance description	8
2.1	Extraction model	8
2.2	Recirculation model	8
2.3	Features	9
2.4	Construction	10
2.5	Operating elements	11
3	Operation	12
4	Care and maintenance	14
4.1	Cleaning the housing	14
4.2	Cleaning the illumination cover	14
4.3	Cleaning the grease filters	15
4.4	Replacing the standard activated charcoal filter	17
4.5	Cleaning and replacing long-life activated charcoal filters	18
4.6	Replacing the LED light bulb	19
5	Trouble-shooting	20
5.1	What to do if ...	20
6	Accessories and spare parts	21
7	Technical data	22
8	Disposal	23
9	Notes	24
10	Index	25
11	Repair service	27
12	Quick instructions	28

1 Safety precautions



The appliance corresponds to recognised technology standards and the relevant safety regulations. Proper use of the appliance is however essential to avoid damage and accidents. Please therefore follow the precautions given in these operating instructions.

In accordance with the requirements of IEC 60335-1:

- This appliance is not intended for use by persons (including children) with reduced physical, sensory or mental capabilities, or lack of experience and knowledge, unless supervised or unless they have been given instruction concerning the use of the appliance by a person responsible for their safety.

1.1 Before using for the first time

- The appliance must be installed and connected up to the electricity supply according to the separate installation instructions. The necessary work should be carried out by a qualified fitter or electrician.
- Dispose of the packaging material in accordance with local regulations.

1.2 Correct use

- The appliance is designed for use in the home for extracting cooking fumes and smells from above the cooking surface.
- Any repairs, modifications or manipulations to the appliance, especially any electrically live parts, should only be carried out by the manufacturer, its Customer Services or similarly qualified persons. Repairs if carried out incorrectly may cause serious injury, damage to the appliance and fittings, as well as affect the functioning of the appliance. If the appliance is not working properly or in case of a repair order, follow the instructions given in the **REPAIR SERVICE** section. Please contact our Customer Services if necessary.
- Use original spare parts only.
- Retain these operating instructions for future reference. If you sell or pass the appliance on to a third party, please ensure these operating instructions, together with the installation instructions, accompany the appliance. In this way, the new owner can inform themselves about how to use the appliance correctly and read the pertinent safety precautions.

1.3 Children in the home

- Packaging material e.g. plastic and polystyrene can be dangerous for children. Danger of suffocation! Please keep packaging material away from children.
- The appliance is designed for use by adults who are familiar with these operating instructions. Children are often unable to recognise the danger of electrical appliances. Ensure proper supervision and do not allow children to play with the appliance – there is a danger that children could hurt themselves.

1.4 Note on use

- If the appliance is visibly damaged, do not use it. Contact our Customer Services.
- If the appliance is not operating properly, disconnect it from the electricity supply immediately.
- If the mains cable of the appliance is damaged, it must be replaced by Customer Services in order to avoid hazard.
- Caution: Accessible parts may become hot when used with cooking appliances.
- Do not flambé food underneath the hood as the grease filters if laden with grease could catch fire.
- If frying on the cooking surface, do not leave the frying appliance unattended. The cooking oil in the frying appliance could overheat and catch fire. Constantly monitor the temperature of the cooking oil, keeping it below the temperature at which it can catch fire. Change the cooking oil regularly – dirty oil catches fire more easily than clean oil.
- Clean the filters regularly. Failure to do so can increase the fire hazard due to the build-up of grease in the grease filter.
- Do not operate the individual cooking zones of the cooking surface without a pan on them or with an empty pan on them so as to avoid damaging the appliance or the kitchen fittings through a build-up of heat. Avoid open fires with oil, gas, wood and coal fired cookers.
- Ensure there is adequate ventilation when the extraction fan is on so as to avoid creating a disturbing underpressure in the kitchen and to achieve optimal air extraction.
- Avoid a cross-current of air, which could blow the cooking vapours over the cooking area.

- If other appliances – fuelled by gas or other fuels – are being used at the same time, ensure that there is a sufficient supply of fresh air. This does not apply to air recirculation appliances.
- If other firing systems are being used at the same time (e.g. wood, gas, oil or coal-fired heating appliances), safe operation is only possible providing a room negative pressure of 4 Pa (0.04 mbar) is not exceeded at the location of the appliance. Risk of toxic fumes! An adequate flow of fresh air must be guaranteed e.g. via non-closable openings in doors or windows and in combination with an air-intake/exhaust-air wall box or by other technical means.
- When carrying out maintenance work on the appliance, including replacing the light bulb, cut off the electricity supply to the appliance (remove the screw fuse from the holder or switch the circuit breaker off, or disconnect from the mains supply).
- When cleaning the appliance make sure no water gets inside the appliance. Use a moderately damp cloth. Do not spray the inside or outside of the appliance with water. Do not use a steam cleaner. If water gets inside the appliance, it can cause damage.

2 Appliance description

The appliance is used to extract cooking fumes and smells from a cooking area and is normally installed in an overhead unit. This particular model can be used in the extraction mode or the recirculation mode.

2.1 Extraction model

The integrated fan extracts cooking fumes and smells from above the cooking surface. The air is cleaned through the grease filters and then fed through the exhaust air conduit to the outside.



When the appliance is in use, ensure there is a sufficient supply of fresh air to replace the air that is being extracted.

2.2 Recirculation model

Using an activated charcoal filter in the appliance

After being filtered through the grease filters, the cooking fumes and smells above the cooking surface are passed through an activated charcoal filter. The cleaned air is then circulated through the grille – at the top of the appliance – and back into the room.

Using an LRC1 air recycling cassette

The appliance extracts the cooking fumes and smells from above the cooking surface through the grease filters, which remove the grease particles. The air is then blown via a duct through the air recycling cassette. An activated charcoal filter in the air recycling cassette removes the cooking fumes and smells. The cleaned air is then circulated through the outlet grille back into the room.



The activated charcoal filter is more effective at the lower power levels.

2.3 Features

- Flat pull-out deflector plate
- 2 extractor fans with 3 power levels
- 2 metal grease filters
- Illumination
- 1 activated charcoal filter (not included in scope of delivery)

The extractor fans have 3 power levels: 1, 2 and 3

- 1 = low, 2 = medium, 3 = high extraction rates.
- Power levels 1 and 2 are suitable for continuous operation.
- Power level 3 (high) is used for short bursts of intensive extraction of cooking fumes and smells, e.g. when searing meat. Afterwards, switch back to power level 1 or 2.



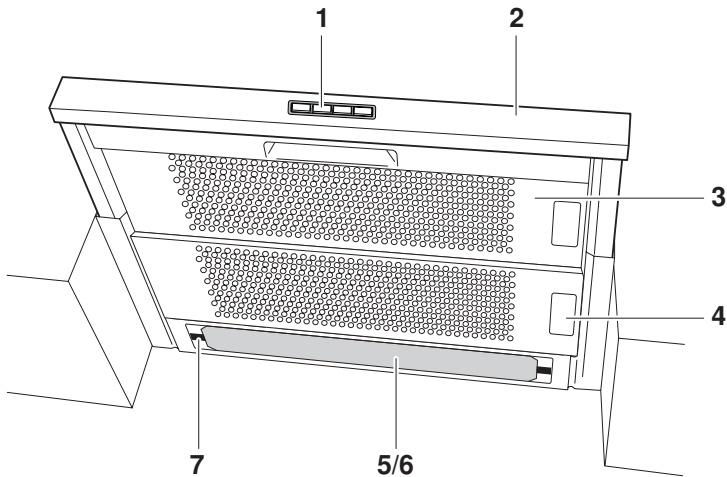

2.4 Construction

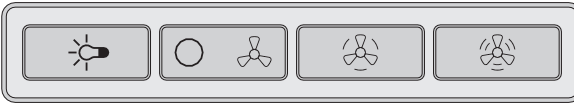

- 1 Operating element
- 2 Flat pull-out deflector plate
- 3 Metal grease filter
- 4 Grip flap
- 5 Illumination
- 6 Illumination cover
- 7 Locking slide

2.5 Operating elements



-  Illumination ON-OFF
-  Extractor fan power level 1 ON, all power levels OFF
-  Extractor fan power level 2 ON-OFF
-  Extractor fan power level 3 ON-OFF



Depending on the model and features, the specification of your appliance may differ from the standard specification described.

3 Operation

Switching the appliance on

- ▶ Pull the deflector plate out.





To switch the illumination and the extractor fan on, the deflector plate must be slightly pulled out.

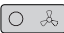

The appliance is most effective when the deflector plate is fully pulled out.

Switching the extractor fan on/off

- ▶ Power level 1 ON: Press the  button 1x.
- ▶ Power level 2 ON: Press the  button 1x.
- ▶ Power level 3 ON: Press the  button 1x.

Switching from power level 3 to power level 2:

- ▶ Press the  button 1x.

Switching from power level 2 to power level 1:

- ▶ Press the  button 1x.



Switching all power levels off:

- ▶ Press the  button 1x.



We recommend switching the appliance on at power level 1 some 5 minutes before starting to cook. After finishing cooking, allow the appliance to run for around another 15 minutes so that the cooking fumes and smells can be extracted.

Switching the illumination on/off

- To switch on: Press the  button 1x.
- To switch off: Press the  button again.

Switching the appliance off

- Push the deflector plate completely in.
 - This switches off the extractor fan and the illumination even if both are still switched on.



If the deflector plate is pulled slightly out again, the extractor fan switches on at the level set and the illumination comes on.

4 Care and maintenance

4.1 Cleaning the housing



Take care that no water gets into the housing of the appliance! If water gets into the housing, it can cause damage.

Do not use abrasive cleaners, scouring pads, steel wool, etc. as they can damage the surface.

Remove the screw fuse or switch off the circuit breaker.

Cleaning the outside/inside

- Clean the outside using a slightly damp cloth – and detergent if necessary – and wipe dry.

Grease and condensate water can build up on the inside next to the grease filters.

- Clean using a slightly damp cloth – and detergent if necessary – and wipe dry.

4.2 Cleaning the illumination cover



The sides are only placed on the glass!

If need be, the illumination cover **1** can be removed for cleaning.

Open the illumination cover **1**:

- Push back both locking bars **2** and swing the illumination cover down.
- Clean the illumination cover in soapy water.

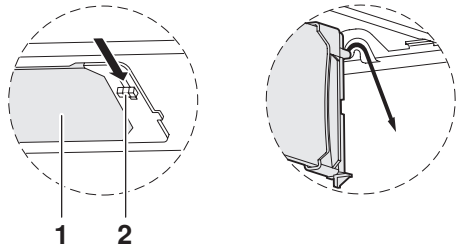

4.3 Cleaning the grease filters

The grease filters should be cleaned at least once a month with normal use. If properly cared for, the grease filters should provide unlimited years of service.

- The grease filters can be cleaned in a dishwasher.
- Select an «intensive» – or «heavy soil» – wash programme with a warm pre-wash.



Cleaning may cause the grease filters to become discoloured. However, this will not affect the functioning of the filters in any way.

If you do not have a dishwasher:

- Clean the grease filters in the sink with hot water and detergent.
- Then soak the filters in hot water in the sink for about 2 hours and finally clean with a washing-up brush.

Removing the grease filters

- Push the deflector plate **1** completely in.
- Press right or left edge of grip flap **2** so that it folds down and can be gripped.
- Hold the grip **2** and pull towards the middle of the appliance.
 - This releases the grease filter, allowing it to be removed.
- Remove the upper grease filter in the same way.
- Clean the grease filters.

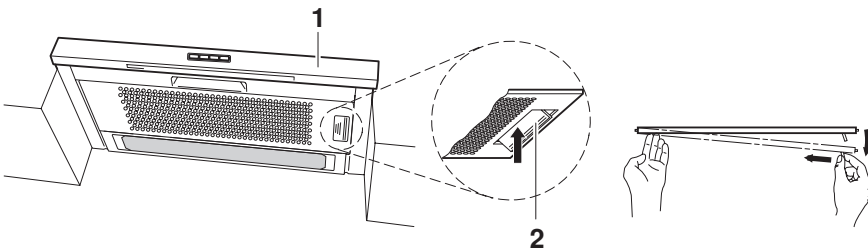

Installing the grease filters

- Push the deflector plate **1** completely in.
- Holding the grease filter, guide the centring pins on one side (either left or right) into the receiving slots for the upper grease filter.
- With the grip flap **2**, pull back and engage the centring pins on the other side.



All centring pins must sit correctly in the receiving slots. Only then can the grip flap **2** - applying light pressure - be folded back up. It must be flush with the grease filter.

- Install the lower grease filter in the same way.

4.4 Replacing the standard activated charcoal filter



Remove screw fuse for the appliance or switch off circuit breaker.

Standard activated charcoal filters are only used in the recirculation model.

The standard activated charcoal filter is to be replaced after an operating time of 3 to 6 months. Activated charcoal filters cannot be washed or regenerated.



The spent standard activated charcoal filter can be disposed of with the household waste.

- Remove both metal grease filters **1**.
- Press the two red retaining slides **2** on the standard activated charcoal filter **3** upwards and at the same time lift the filter down and out of its fixture **4**.
- Slide the new filter up under the clip and secure in the fixture **4**. To do this snap the red retaining slides **2** into place.
- Put back both metal grease filters **1**.
- Put the screw fuse back in or switch the circuit breaker on again.

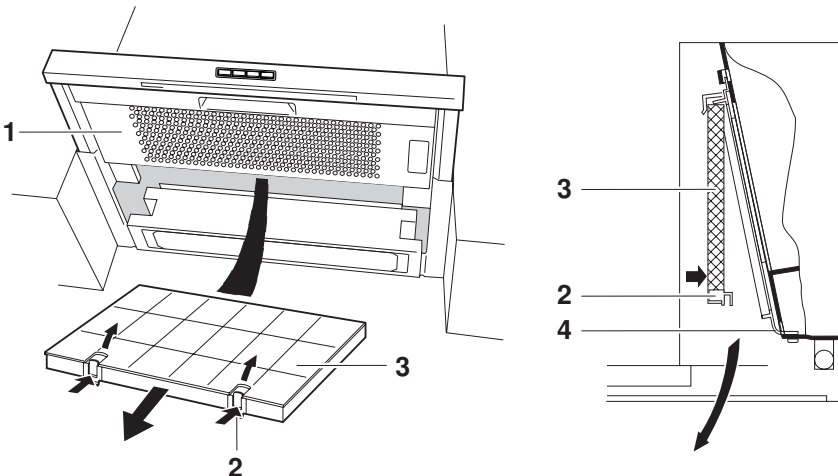

4.5 Cleaning and replacing long-life activated charcoal filters



Remove screw fuse or switch off circuit breaker.

Long-life activated charcoal filters are only used in the recirculation model.

Unlike the standard activated charcoal filter, the long-life activated filter can be cleaned and reactivated. With normal use of the appliance, the long-life activated charcoal filter should be cleaned every month. The long-life activated charcoal filter can be washed in the dishwasher at 65 °C (intensive programme). The long-life activated charcoal filter should be washed separately, so that no food remains can become stuck to the filter. If you don't have a dishwasher, the long-life activated charcoal filter can also be soaked in the sink for an hour at 60 °C using normal washing-up liquid. Then rinse well.

To reactivate the activated charcoal, the long-life activated charcoal filter must be dried in the oven without its frame.

- ▶ Select top and bottom heat or hot air at 100 °C and leave the long-life activated charcoal filter to dry for 60 minutes on the wire shelf.



After about three years the long-life activated charcoal filter must be replaced because its ability to absorb smells will be reduced. The dirty long-life activated charcoal filter can be disposed of along with the domestic waste.

- ▶ Remove and clean the metal grease filters.
- ▶ Remove and reactivate the long-life activated charcoal filter or replace with the new filter.
- ▶ Replace the metal grease filters.
- ▶ Put screw fuse back in or switch circuit breaker on again.

4.6 Replacing the LED light bulb



Remove the appliance's screw fuse or switch off the circuit breaker.

LED light bulbs get warm during operation! Allow to cool down first.

Open the illumination cover **1**:

- Push back both locking slides **2** and swing down the illumination cover.
- Replace the damaged lamp.
Use only max. 3W-E14 LED lamps.
- Close the illumination cover **1**.
- Put back the screw fuse or switch on the circuit breaker again.

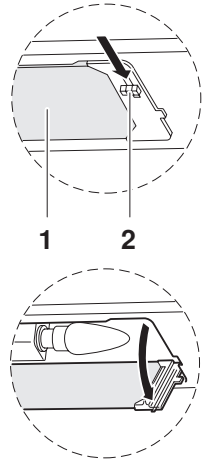

5 Troubleshooting

5.1 What to do if ...

... the illumination is not working

Possible cause	Solution
<ul style="list-style-type: none">• The fuse or the circuit breaker for electrical installations in the home is faulty.	<ul style="list-style-type: none">➤ Replace the fuse.➤ Reset the circuit breaker.
<ul style="list-style-type: none">• Interruption in the power supply.	<ul style="list-style-type: none">➤ Check the mains supply.
<ul style="list-style-type: none">• The LED light bulb is defective.	<ul style="list-style-type: none">➤ Replace the LED light bulb.

... the appliance is not extracting enough air

Possible cause	Solution
<ul style="list-style-type: none">• The grease filters are dirty.	<ul style="list-style-type: none">➤ Clean the grease filters.
<ul style="list-style-type: none">• The activated charcoal filter (in recirculation models) is spent.	<ul style="list-style-type: none">➤ Replace the standard activated charcoal filter.➤ Clean or replace the long-life activated charcoal filter.

6 Accessories and spare parts

Please give model number of the appliance and exact description of the accessory or spare part when ordering parts.

LED light bulb (230V / 3W / E14)

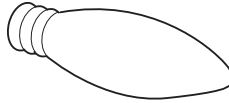

Metal grease filter

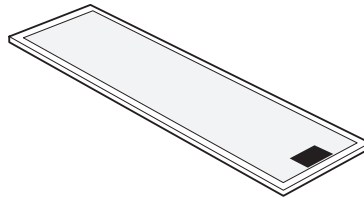

Standard activated charcoal filter

Long-life activated charcoal filter

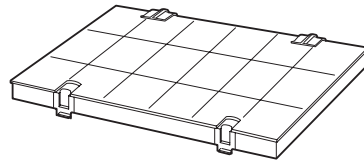

LED light bulbs are also available from specialist retailers.

7 Technical data

Electrical connection

- See identification plate.
 - Remove the grease filter.
 - The identification plate is located on the inside of the appliance.

8 Disposal

Packaging

- All packaging materials (cardboard, plastic film (PE) and polystyrene (EPS)) are marked and should, if possible, be collected for recycling and disposed of in an environmentally friendly way.

Disconnection

- Disconnect the appliance from the mains power supply. With a fixed appliance, this is to be carried out by a qualified electrician!

Safety

- Disable the appliance to prevent accidents caused by improper use, especially through children playing.
- Pull the plug out of the mains socket or have the appliance disconnected from the mains by an electrician. Then cut the mains cable off flush with the appliance.

Disposal

- The old appliance should not be discarded as worthless rubbish. If disposed of correctly, the raw materials can be recovered for recycling.
- The  symbol on the identification plate warns that the appliance may not be disposed of in normal household waste.
- The appliance must be disposed of in accordance with local regulations on waste disposal. For more information on the handling, disposal and recycling of the product, please contact the local authorities, the local recycling facilities for household waste or the retailer from whom you purchased the appliance.

9 Notes

10 Index

A

Accessories	21
Ordering	27
Activated charcoal filter	8
Air recycling cassette	8

C

Care	14
Children in the home	5
Cleaning	14
Grease filter	15
Construction	10

D

Deflector plate	10
Disconnection	23
Disposal	23

E

Electrical connection	22
Extraction model	8
Extractor fan	12

F

Features	9
--------------------	---

G

Grease filter	10
Cleaning	15
Installing	16
Removing	16
Grip flap	10

I

Identification plate	22
Illumination	10, 13

L

Locking slide	10
Long-life activated charcoal filter	
Cleaning	18
Replacing	18

M

Maintenance	14
Model number	2

O	
Operating element	10
Operating elements	11
Operation	12
Orders	27
P	
Packaging	23
Power level	
Selecting	12
Q	
Queries	27
Quick instructions	28
R	
Recirculation model	8
Repair service	27
S	
Safety	23
Safety precautions	
Before using for the first time	4
Children in the home	5
Correct use	5
Note on use	6
Service agreement	27
Service Centre	27
Spare parts	21
Ordering	27
Standard activated charcoal filter	
Replacing	17
Switching off	13
Switching on	12
Symbols	2
T	
Technical data	22
Trouble-shooting	20
Type	2
U	
Using for the first time	4

11 Repair service



The **TROUBLE-SHOOTING** section will help you to carry out small repairs yourself, saving you the time and trouble of calling out a service technician and the cost that goes along with it.

Whether you contact us about a malfunction or an order, please always state the serial number (FN) and the model type of your appliance. Enter these details below and also on the service sticker which comes with the appliance. Stick it in a conspicuous place or in your telephone or address book.

FN

Appliance

You will also find the same details on the certificate of guarantee, the original sales invoice and the identification plate of the appliance.

- ▶ Remove metal grease filter.
 - The identification plate is located on the inside of the appliance.

If the appliance is not working properly, contact your nearest V-ZUG Ltd Service Centre using freephone 0800 850 850 and stand in close proximity to the appliance.

Queries, orders, service agreement

For administrative and technical queries or problems, as well as for ordering spare parts and accessories, please contact our head office in Zug on telephone number +41 (0)58 767 67 67.

As regards the maintenance of all our products, when the warranty expires you have the option of taking out a service agreement. We will be happy to send you the necessary forms.

12 Quick instructions

Please first read the safety precautions in these operating instructions!

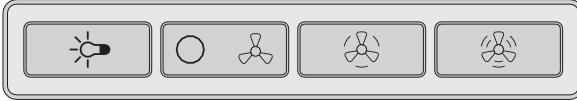



To switch on

- Pull out the deflector plate.

Illumination

- Press the  button 1x.

Extractor fan

- Press the  button 1x (power level 1).
- Press the  button 1x (power level 2).
- Press the  button 1x (power level 3).

To switch off

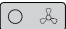
- Press the  button again.
- Press the  button again
- or push in the deflector plate.

V-ZUG Ltd

Industriestrasse 66, 6302 Zug
Tel. +41 (0)58 767 67 67, Fax +41 (0)58 767 61 61
info@vzug.com, www.vzug.com
Service Centre: Tel. 0800 850 850



J32813-R02