

Operating instructions

DFSE 5/6 | AiroClearCabinet V400

Range hood

Thank you for choosing to buy one of our products. Your appliance is made to high standards and is easy to use. Nevertheless, please take the time to read these operating instructions in order to familiarize yourself with the appliance and get the best use out of it.

Please follow the safety precautions.

Modifications

Text, diagrams and data correspond to the technical standard of the appliance at the time these operating instructions went to press. The right to make technical modifications for the purpose of the further development of the appliances is reserved.

Validity

The model number corresponds to the first alphanumeric on the identification plate. These operating instructions apply to:

Model designation	Model number	Type	Size system
AiroClearCabinet V400	61066	AE4H5FE	55
AiroClearCabinet V400	61067	AE4H6FE	60
DFSE5	61028	DFSE5	55
DFSE6	61029	DFSE6	60

Variations depending on the model are noted in the text.

Inhaltsverzeichnis

1	Safety precautions	4	10	Notes	21
1.1	Symbols used.....	4	11	Service & Support	23
1.2	General safety precautions.....	4		Quick instructions	24
1.3	Before using for the first time.....	5			
1.4	Correct use	5			
1.5	Note on use.....	5			
2	Appliance description	7			
2.1	Introduction	7			
2.2	Extraction mode.....	7			
2.3	Recirculation mode	7			
2.4	Features.....	7			
2.5	Construction	8			
2.6	Operating elements.....	8			
3	Operating the appliance	9			
3.1	Using for the first time	9			
3.2	Switching the appliance on	9			
3.3	Extractor fan	9			
3.4	Intensive level.....	10			
3.5	After-running time	10			
3.6	Illumination	10			
3.7	Switching the appliance off.....	10			
3.8	Saturation indicator	11			
4	Care and maintenance	11			
4.1	Cleaning the housing.....	11			
4.2	Metal grease filters.....	12			
4.3	Long-life activated charcoal filter.....	13			
4.4	Standard activated charcoal filter.....	15			
4.5	Replacing the LED light bulbs.....	15			
5	Trouble-shooting	16			
5.1	What to do if... ..	16			
6	Accessories and spare parts	17			
7	Technical data	17			
7.1	Product fiche	18			
8	Disposal	19			
9	Index	20			

1 Safety precautions

1.1 Symbols used



Denotes important safety precautions.

Failure to observe said precautions can result in injury or in damage to the appliance or fittings!



Information and precautions that should be observed.



Information on disposal



Information about the Operating Instructions

- ▶ Indicates step-by-step instructions.
 - Describes how the appliance reacts to the steps taken.
- Indicates a list.

1.2 General safety precautions



- Read the operating instructions before using the appliance for the first time.



- This appliance can be used by children aged 8 and above and by persons with reduced physical, sensory or mental capabilities, or lack of experience and/or knowledge, provided they are supervised or have been instructed on the safe use of the appliance and have understood the hazards involved. Children shall not play with the appliance.

Cleaning and user maintenance shall not be undertaken by children without supervision.

- If an appliance is not equipped with a mains cable and a plug or other means for disconnecting from the mains with a contact opening on each pole complying with the conditions of overvoltage category III for full isolation, an isolating device must be incorporated into the permanently installed electrical installation in accordance with the installation regulations.
- If the mains cable of this appliance is damaged, it must be replaced by the manufacturer or its Customer Services or a similarly qualified person in order to avoid hazard.

1.3 Before using for the first time

- The appliance must be installed and connected to the electricity supply in accordance with the separate installation instructions. Have a qualified fitter/ electrician carry out the necessary work.
- Observe the official regulations for the exhaust-air layout.
- Dispose of the packaging material in accordance with local regulations.

1.4 Correct use

- The appliance is designed for use in the home for extracting cooking fumes and smells from above the cooking surface.
- Any repairs, modifications or manipulations to the appliance, especially any electrically live parts, may only be carried out by the manufacturer, its customer service department or similarly qualified persons. Repairs if carried out incorrectly may cause serious injury, damage to the appliance and fittings, as well as affect the functioning of the appliance. If the appliance is not working properly or in case a repair is needed, follow the instructions given in the 'Service & Support' section. Contact our Customer Services if necessary.
- Use original spare parts only.
- Retain these operating instructions for future reference.

1.5 Note on use

- If the appliance is visibly damaged, do not use it. Contact our Customer Services.
- If the appliance is not functioning properly, disconnect it from the power supply immediately.
- Ensure there is adequate ventilation when the extractor fan is on so as to avoid creating underpressure in the kitchen and to achieve optimal air extraction.

- Avoid a cross-current of air, which could blow the cooking vapours over the cooking area.
- If other appliances – fired by gas or other fuels – are being used at the same time, ensure that there is a sufficient supply of fresh air. This does not apply to air recirculation appliances.
- If other firing systems are being used at the same time (e.g. wood, gas, oil or coal fired heating appliances), safe operation is only possible providing a room negative pressure of 4 Pa (0.04 mbar) is not exceeded at the location of the appliance. Risk of toxic fumes! An adequate flow of fresh air must be guaranteed e.g. via non-closable openings in doors or windows and in combination with an air-intake/exhaust-air wall box or by other technical means.
- When cleaning the appliance make sure no water gets inside it. Use a moderately damp cloth only. Do not spray the inside or outside of the appliance with water. Do not use a steam cleaner. If water gets inside the appliance, it can cause damage.
- Accessible parts may become hot when used with cooking appliances.

Caution: Burns hazard!

- Do not leave the appliance unattended when deep-frying on the cooking surface. The cooking oil in the deep-frying appliance could overheat and catch fire. Constantly monitor the temperature of the cooking oil, keeping it below the temperature at which it can catch fire. Change the cooking oil regularly – dirty oil catches fire more easily than clean oil.

Caution: Risk to life!

- Packaging material, e.g. plastic film and polystyrene, can be dangerous for children and animals. Danger of suffocation! Keep packaging material away from children and animals.

1 Safety precautions

- When carrying out maintenance work on the appliance, including replacing light bulbs, cut off the electricity supply to the appliance: remove the screw fuse from the holder or switch the circuit breaker off, or disconnect from the mains supply.

How to avoid damaging the appliance

- Observe the cleaning intervals. Failure to do so can increase the fire hazard due to the build-up of grease in the metal grease filters.

2 Appliance description

2.1 Introduction

The appliance is designed for use in the home for extracting cooking odours from above a cooking area and can be used in the extraction or recirculation mode.



Extraction mode



Recirculation mode

2.2 Extraction mode

A fan extracts cooking fumes and smells from above the cooking surface. The metal grease filters clean the extracted air, which is then passed through a connecting pipe fitted with an integrated non-return valve and through the air duct to the outside.



When in use, ensure there is a sufficient supply of fresh air to replace the air that is being extracted.

2.3 Recirculation mode

After being filtered through the metal grease filters, the cooking fumes and smells above the cooking area are passed through an activated charcoal filter. The filtered air is then circulated back into the room through the side openings.



If activated charcoal filters are not supplied with the appliance, these should be ordered and installed before using the appliance for the first time.

2.4 Features

- Flat pull-out deflector plate
- 2 metal grease filters
- Illumination
- 1 activated charcoal filter (only for recirculation mode, not included in the scope of delivery)
- 1 extractor fan with 4 power levels
 - Level 1 = low, 2 = medium, 3 = high extraction rate
 - Power level 4 (intensive) is used for short bursts of intensive extraction of cooking smells and fumes, e.g. when searing meat. Afterwards, switch back to power level 1, 2 or 3.



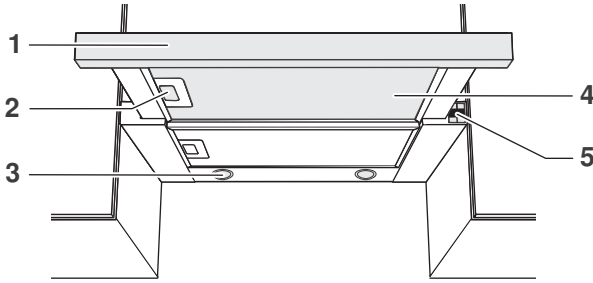

2.5 Construction

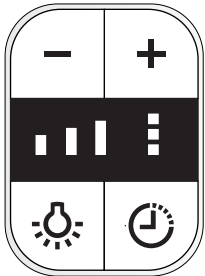

- 1 Flat pull-out deflector plate
- 2 Grip
- 3 LED illumination
- 4 Metal grease filters
- 5 Operating elements

2.6 Operating elements



- Switching the extractor fan off/reducing the power level
- + Switching the extractor fan on/increasing the power level
-  Power level display
-  Intensive level display
-  Switch illumination on/off
-  Reset after-running time/saturation indicator

 Depending on the model and features, the specification of your appliance may differ in individual details from the standard specification described.

3 Operating the appliance

3.1 Using for the first time

Appliance configuration

The model can be used to extract or recirculate air. The appliance is set up ex-factory for use in the extraction mode.



If the appliance is to be operated as an extraction model, the saturation indicator for the activated charcoal filter must be deactivated.

Activating the saturation indicator for the activated charcoal filter

- ▶ Switch the appliance off.
- ▶ Hold the **+** and **-** buttons depressed for 3 seconds.
 - Power levels 1 and 2 flash alternately in the display.
- ▶ The appliance is now configured for the recirculation mode.

Deactivating the saturation indicator for the activated charcoal filter

- ▶ Switch the appliance off.
- ▶ Hold the **+** and **-** buttons depressed for 3 seconds.
 - Power level 1 flashes in the display.
- ▶ The appliance is now configured for the extraction mode.

3.2 Switching the appliance on

To switch the extractor fan on, the deflector plate must be pulled out.

- ▶ Pull the deflector plate out.

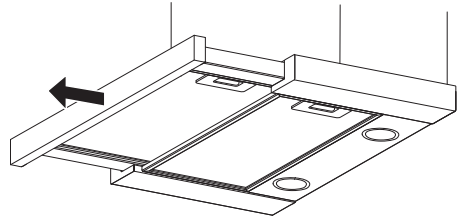

The appliance is most effective when the deflector plate is fully pulled out.

3.3 Extractor fan

- ▶ Touching the **+** button switches the extractor fan on at level 1.
- ▶ To select the next highest level touch the **+** button again.
- ▶ Touch the **-** button to select the next lowest level or to switch the extractor fan off.



We recommend switching the appliance on at level 1 some 5 minutes before starting to cook. Leave the appliance running for about 15 minutes after cooking to extract all the cooking smells.

3.4 Intensive level

- ▶ Touch the **+** button repeatedly until **III** (intensive level 3) flashes in the display.
- ▶ The appliance switches back to level 2 after 5 minutes.
- ▶ Touch the **-** button to stop the intensive level before the 5 minutes has elapsed.

3.5 After-running time

- ▶ Switch the appliance on.
- ▶ Select the desired power level.
- ▶ Touching the **⌚** button activates the after-running time.
 - While the after-running time is activated, the **III** display flashes according to the table below and then switches off automatically.

Level	After-running time
1	20 minutes
2	15 minutes
3	10 minutes
Intensive	5 minutes

3.6 Illumination

- ▶ Press the **💡** button to switch the illumination on.
- ▶ Press the **💡** button repeatedly to switch the illumination off.

 The illumination does not switch off automatically when the deflector plate is pushed in.

3.7 Switching the appliance off

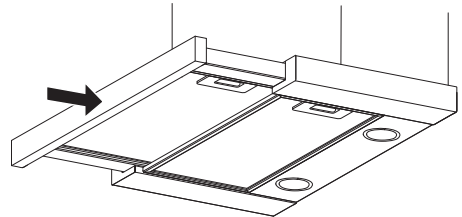

- ▶ Push the deflector plate completely in.
 - The extractor fan is switched off.
 - The settings are saved.





 If the deflector plate is pulled slightly out again, the extractor fan comes on at the level previously set.

3.8 Saturation indicator

Metal grease filters

The  (power level) and  (intensive level) indicators flash alternatively after 40 operating hours. The saturation level has been reached and the metal grease filters must be cleaned.

Long-life and standard activated charcoal filters

The  (power level) and  (intensive level) indicators flash simultaneously after 160 operating hours. The saturation level has been reached. The long-life activated charcoal filter has to be cleaned and reactivated. The standard activated charcoal filter cannot be reused and must be replaced.



Only activate this function if the appliance is being used in the recirculation mode.

4 Care and maintenance

4.1 Cleaning the housing



Take care that no water gets into the housing of the appliance! If water gets into the housing, it can cause damage.

Do not use abrasive cleaners, scouring pads, steel wool, etc. for cleaning, as they can damage the surface. Disconnect the appliance from the mains and unscrew the fuse or switch off the automatic circuit breaker.

Cleaning the outside/inside

- ▶ Clean the outside of the appliance with a warm, damp cloth and a little detergent and then wipe dry.
 - Grease and condensate water can build up on the inside around the metal grease filters.
- ▶ Clean with a warm, damp cloth and a little detergent – you can also use a brush if necessary – and then wipe dry with a kitchen towel.

4.2 Metal grease filters

The metal grease filters must be cleaned at least once a month with normal use. If properly cared for, the grease filters should provide years of service.

Removing

 **Using both hands, carefully remove the metal grease filters, making sure not to drop or damage them.**

- ▶ Pull the deflector plate **1** completely out.
- ▶ Push the grip **2** on the grease filter in.
 - This releases the grease filter **3**.
- ▶ Carefully pull the grease filter **3** down and out of the fixture.
- ▶ Clean the grease filter **3**.

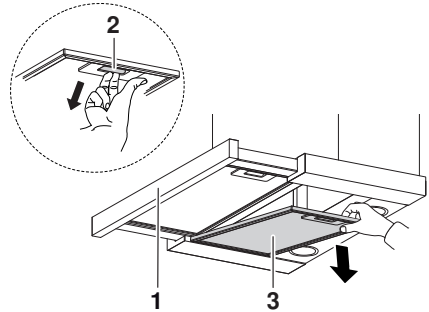

Cleaning

- ▶ Clean the grease filters **3** in the dishwasher.
- ▶ Select an «intensive» or «heavy» wash programme with a warm prewash.

 Cleaning may cause the metal grease filters to become slightly discoloured. However, this will not affect the functioning of the filters in any way.

If no dishwasher is available:

- ▶ Clean the grease filters **3** in the sink with hot water and detergent.
- ▶ Then soak the grease filters **3** in hot water in the sink for about 2 hours and finally clean with a washing-up brush. Rinse well with clean cold water.

Installing

- ▶ Reassemble in the reverse order.

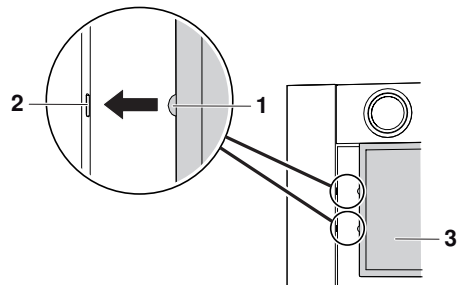



 Ensure all centring pins **1** are positioned properly in the receiving slots **2**.

Resetting the saturation indicator

With the appliance switched on, hold the  button depressed for 3 seconds to reset the saturation indicator.

- ▶ The  (power level) and  (intensive level) displays illuminate for 2 seconds if reset correctly.



If both the  and  displays are flashing after the reset, the reason for this is: the metal grease or activated charcoal filters are also dirty and must be cleaned or replaced.

4.3 Long-life activated charcoal filter

The long-life activated charcoal filter must be cleaned and reactivated bimonthly with normal use or whenever the saturation indicator flashes. If properly cared for, the service life of the long-life activated charcoal filter is 3 years.



Disconnect the appliance from the mains and unscrew the fuse for the appliance or switch off the circuit breaker.

Removing

- ▶ Pull the deflector plate completely out and remove both grease filters.
- ▶ Push bar **1** and move the activated charcoal filter unit **2** down and out of the bracket.
- ▶ Remove the activated charcoal filter mat **3** from its frame **4**.

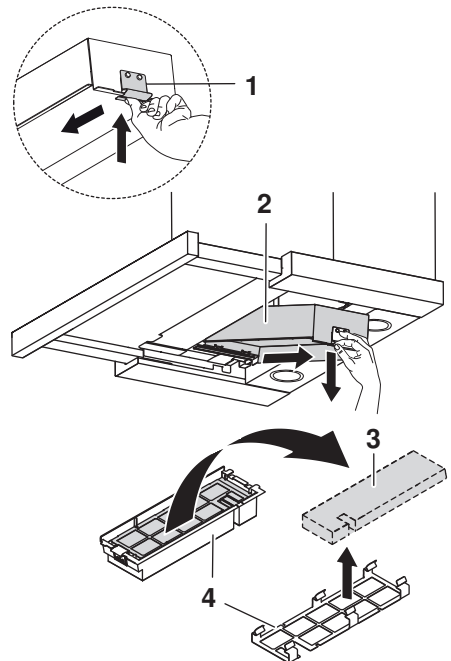

Cleaning and reactivating

- ▶ Clean the activated charcoal filter mat **3** in the dishwasher.
- ▶ Select an «intensive» or «heavy» dishwasher programme with a warm prewash. Wash separately so that no food debris can become stuck to the activated charcoal filter mat filter **3**.

If no dishwasher is available:

- ▶ Clean the activated charcoal filter mat **3** with hot water and detergent and then soak in hot water in the sink for an hour. Rinse well afterwards.
- ▶ To reactivate the activated charcoal, the activated charcoal filter mat **3** without the frame **4** must be dried in the oven.
- ▶ Select top/bottom heat or hot air and set the temperature to 100 °C. Place the activated charcoal filter mat **3** on the wire shelf and allow to dry for an hour.



The spent long-life activated charcoal filter can be disposed of in the household waste or at a suitable recycling point.

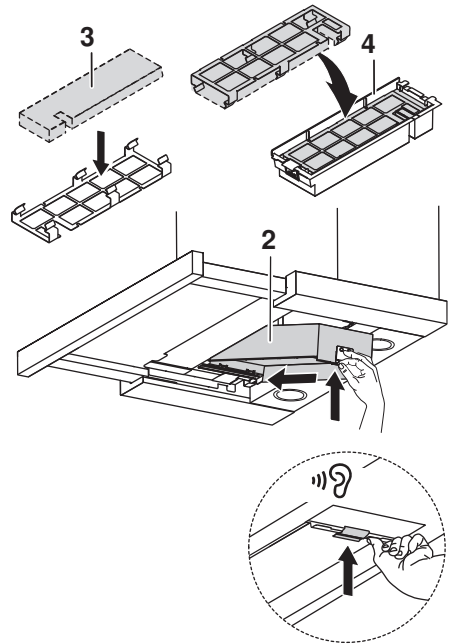

Installing

- ▶ Insert the activated charcoal filter mat **3** into the frame **4**.
- ▶ Insert the activated charcoal filter unit **2** into the bracket and press down firmly.
- ▶ Insert both grease filters again and close the deflector plate.
- ▶ Switch the fuse on.





Resetting the saturation indicator

With the appliance switched on, hold the  button depressed for 3 seconds to reset the saturation indicator.

- ▶ The  (power level) and  (intensive level) displays illuminate for 2 seconds if reset correctly.



If both the  and  displays are flashing after the reset, the reason for this is: the metal grease or activated charcoal filters are also dirty and must be cleaned or replaced.

4.4 Standard activated charcoal filter

The standard activated charcoal filter is to be replaced after an operating time of 3 to 6 months. Standard activated charcoal filters cannot be washed or regenerated.



Disconnect the appliance from the mains and unscrew the fuse for the appliance or switch off the circuit breaker.

Removing/Installing

- ▶ Pull the deflector plate completely out and remove both grease filters.
- ▶ Push bar **1** and move the activated charcoal filter unit **2** down and out of the bracket.
- ▶ Replace and dispose of the spent activated charcoal filter unit **3**.
- ▶ Reassemble in the reverse order.

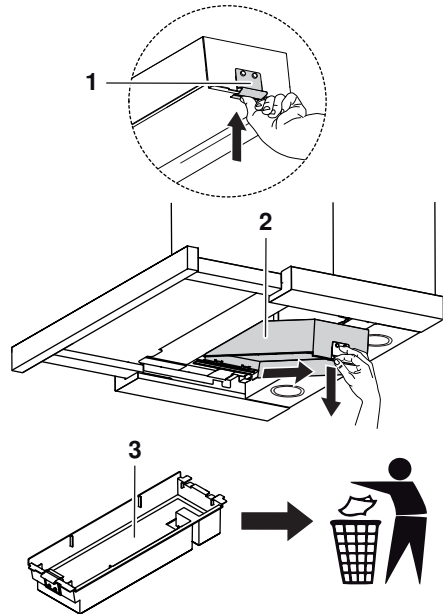

The spent standard activated charcoal filter can be disposed of in the household waste or at a suitable recycling point.

4.5 Replacing the LED light bulbs

For safety reasons, the LED light bulbs must be replaced by our Customer Services.

5 Trouble-shooting

5.1 What to do if...

... the illumination is not working

Possible cause	Solution
<ul style="list-style-type: none"> ▪ Fuse or automatic circuit breaker for electrical installations in the home is defective. 	<ul style="list-style-type: none"> ▶ Replace the fuse. ▶ Reset the automatic circuit breaker.
<ul style="list-style-type: none"> ▪ An interruption in the power supply. 	<ul style="list-style-type: none"> ▶ Check the power supply.
<ul style="list-style-type: none"> ▪ LED light bulb is defective. 	<ul style="list-style-type: none"> ▶ Contact Customer Services.

... the appliance is not extracting enough air

Possible cause	Solution
<ul style="list-style-type: none"> ▪ The metal grease filters are dirty. 	<ul style="list-style-type: none"> ▶ Clean the metal grease filters.
<ul style="list-style-type: none"> ▪ Only for recirculation mode: The activated charcoal filters are saturated. 	<ul style="list-style-type: none"> ▶ Clean and reactivate or replace the activated charcoal filters.
<ul style="list-style-type: none"> ▪ Only for extraction mode: The fresh air intake is insufficient. 	<ul style="list-style-type: none"> ▶ Ensure the fresh air intake is sufficient.

6 Accessories and spare parts

Please give model number of the appliance and exact designation of the accessory or spare part when ordering parts.

Metal grease filters

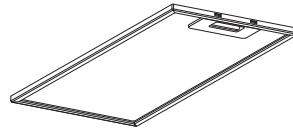

Long-life activated charcoal filter

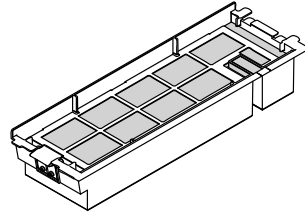

Standard activated charcoal filter

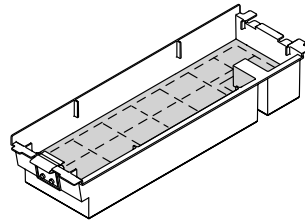

7 Technical data

Electrical connection

- ▶ See identification plate.
- ▶ Remove the metal grease filters.
 - The identification plate is located on the inside of the appliance.

7.1 Product fiche

In accordance with EU Regulation No. 65/2014 and No. 66/2014.

Description	Abbreviations	Unit	Value
Brand	S	-	V-ZUG Ltd
Model identifier	M	-	61028+61029 / 61066+61067
Annual Energy Consumption	AEC _{hood}	kWh/a	43.4 / 98.0
Energy Efficiency Index	EEl _{hood}	%	51.3 / 96.4
Energy Efficiency Class	EEC	-	A / D
Fluid Dynamic Efficiency	FDE _{hood}	%	31.9 / 9.0
Fluid Dynamic Efficiency Class	FDEC	-	A / E
Lighting Efficiency	LE _{hood}	lux/W	29.0 / 76.1
Lighting Efficiency Class	LEC	-	A / A
Grease Filtering Efficiency	GFE _{hood}	%	76.0 / 65.1
Grease Filtering Efficiency Class	GFEC	-	C / D
Air flow at minimum speed	Q _{min}	m ³ /h	240.0 / 205.0
Air flow at maximum speed (intensive or boost excluded)	Q _{max}	m ³ /h	515.0 / 310.0
Air flow at intensive or boost setting	Q _{boost}	m ³ /h	625.0 / 410.0
Airborne acoustical A-weighted Sound Power Emissions at minimum speed	SPE _{min}	dBA	47.0 / 48.0
Airborne acoustical A-weighted Sound Power Emissions at maximum speed	SPE _{max}	dBA	63.0 / 55.0
Airborne acoustical A-weighted Sound Power Emissions at intensive or boost setting	SPE _{boost}	dBA	67.0 / 61.0
Measured power consumption of off mode	P ₀	W	- / -
Measured power consumption of standby mode	P _s	W	0.49 / 0.49
Time increase factor	f	-	0.9 / 1.7
Measured air flow rate at the best efficiency point	Q _{BEP}	m ³ /h	336.0 / 235.0
Measured air pressure at the best efficiency point	P _{BEP}	PA	414.0 / 210.0
Measured value of the electric power input at the best efficiency point	W _{BEP}	W	121.0 / 152.0
Nominal power of the lighting system	W _L	W	5.0 / 5.0

Average illumination of the lighting system over the cooking surface	E_{middle}	lux	145.0 / 381.0
Sound power level	L_{wa}	dBA	63.0 / 55.0

8 Disposal

8.1 Packaging



Never allow children to play with packaging material due to the danger of injury or suffocation. Store the packaging material in a safe location or dispose of it in an environmentally-friendly way.

8.2 Safety

Render the appliance unusable to prevent accidents caused by improper use (e.g. through children playing):

- ▶ Disconnect the appliance from the mains. With a fixed appliance, this is to be carried out by a qualified electrician. Then cut the mains cable off flush with the appliance.

8.3 Disposal



-  The «crossed out wheeled bin» symbol requires the separate collection of waste electrical and electronic equipment (WEEE). Such equipment can contain hazardous, environmentally harmful materials.
- These appliances are to be handed over to a designated collection point for the recycling of electrical and electronic equipment and must not be disposed of with unsorted household waste. And in this way, you will be helping to protect resources and the environment.
- For more information, please contact the local authorities.

9 Index

A		
Accessories	17	
Appliance configuration.....	9	
Appliance description	7	
Appliance disposal.....	19	
C		
Care and maintenance	11	
Cleaning		
Activated charcoal filter.....	13	
Housing	11	
Metal grease filters.....	12	
Construction.....	8	
D		
Disposal.....	19	
E		
Electrical connection	17	
Extraction mode	7	
F		
Features.....	7	
I		
Identification plate.....	17	
Illumination	10	
Initial set-up.....	5	
Intensive level	10	
M		
Model designation	2	
Model number	2	
N		
Notes.....	21	
O		
Operating elements	8, 24	
Operating the appliance.....	9	
P		
Product fiche.....	19	
Q		
Queries	23	
R		
Recirculation mode	7	
S		
Safety precautions		
Before using for the first time.....	5	
Correct use	5	
Note on use	5	
Safety warnings		
General	4	
Saturation indicator.....	11	
Service & Support.....	23	
Service agreement.....	23	
Switching off	10	
Switching on	9	
Symbols.....	4	
T		
Technical data	17	
Type.....	2	
V		
Validity.....	2	
W		
What to do if		
the appliance is not extracting enough air		
.....	16	
the illumination is not working.....	16	

10 Notes

11 Service & Support



The «Trouble-shooting» section gives you valuable tips on how to deal with minor malfunctions yourself, saving you the time and trouble of calling out a service technician and any cost that goes along with it.

Information on the V-ZUG warranty can be found at www.vzug.com →Service →Warranty information. Please read this information carefully.

Please register your V-ZUG appliance straightaway:

- online at www.vzug.com →Service →Online warranty registration or
- using the enclosed registration card.

This will allow you to take advantage of the best possible support in the event of a fault in the appliance during the guarantee period. You will require the serial number (SN) and appliance designation to register your appliance. You will find them on the identification plate of your appliance.

My appliance information:

SN: _____ **Appliance:** _____

Please have this appliance information to hand when contacting V-ZUG. Thank you.

- ▶ Remove the metal grease filters.
 - The identification plate is located on the inside of the appliance.
 - A second identification plate is included in the scope of delivery and should be retained for the purpose of appliance identification.

Your repair order

Call the free service number 0800 850 850 to contact your nearest V-ZUG service centre. You can arrange an on-site visit by us by phone if you wish.

General queries, accessories and service agreement

V-ZUG will be happy to help you with any general administrative or technical queries, to accept your orders for accessories and spare parts and to inform you about our progressive service agreements. You can contact us by calling tel. +41 58 767 67 67 or by going to our website at www.vzug.com.

Quick instructions

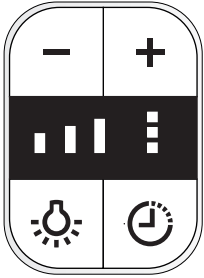

- Switching the extractor fan off/reducing the power level
- +** Switching the extractor fan on/increasing the power level
- ▮▮▮** Power level display
- ⋮** Intensive level display
- 💡** Switch illumination on/off
- 🕒** Reset after-running time/saturation indicator



1020579-R04

